

APPLICATION FOR A PERMIT TO CONSTRUCT A WATER WELL IN THE UPPER NIOBRARA WHITE NATURAL RESOURCES DISTRICT

1. LANDOWNER INFORMATION

NAME: _____
 ADDRESS: _____
 PHONE: (____) - _____
 Contact other than Landowner _____
 Address & Phone _____

DWR AND NRD USE ONLY

Late Permit

Permit No. UNW- _____

Registration No. _____

Chemigation No. _____

GPS _____

Elevation _____

2. PURPOSE OF WELL new well existing well modification.

TYPE (check one)

- Irrigation Domestic Livestock Public Water Supply Dewatering (over 90 days) Geothermal
 Ground Heat Exchanger Commercial / Industrial Recovery Ground Water Source Heat Pump
 Monitoring Aquaculture Other (specify) _____

3. LOCATION OF THE PROPOSED WELL

_____ County, Township _____ North,
 Range _____ West, Section _____ Subsection _____

The well will be located _____ feet from the North South section line, and will be _____ feet from the East West section line. *Please attach aerial photo, if available.*

The box at the right represents a one square mile section. Please indicate in this box: ⊕ the proposed location of the well with an "X", and ⊘ the proposed location of the water use area by outlining the area. If the water is to be used outside of the above written legal description, give the legal description of this area: _____ County, Township _____ North, Range _____ West, Section _____ Subsection _____

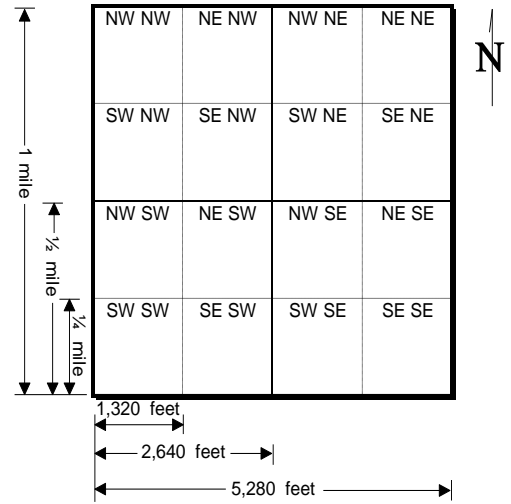

4. IRRIGATION WELL INFORMATION

How many acres will be irrigated? _____ Acres.
 Will a flow meter be used on the proposed new well? Yes No
 What type of irrigation system is planned? Center Pivot Gravity Other (specify) _____
 What type of power supply will be used for the well? Electricity Fuel - type? _____
 Will the well be used in a system with other wells? Yes No If yes, how many? _____
 Will fertilizer, chemicals, or animal waste be applied through the irrigation system? Yes No

5. REPLACEMENT WELL AND WELL ABANDONMENT INFORMATION

Is this a replacement well? Yes No If no, please proceed to section 6. The following questions are for replacement wells only.
 Registration number of the well to be replaced: _____ Well to be replaced was last operated _____, _____.
 Replacement well will be _____ feet from the original well. Original well was decommissioned _____, _____.
 Will the water use area of the new well be the same area as the decommissioned well? Yes No

6. EXPECTED SPECIFICATIONS OF THE WELL AND PUMP (Please attach test hole log, if available)

Approximate date when construction will begin: _____, _____.
 Estimated pump column diameter: _____ inches. Estimated total depth of the well: _____ feet.
 Estimated pumping capacity: _____ gallons per minute. Estimated well casing diameter: _____ inches.
 Well Driller: _____ Address: _____ Phone: _____

7. I certify that I am familiar with the information contained in this application, and its restrictions, rules, and regulations, and that to the best of my knowledge and belief such information is true, complete, and accurate.

This form must be completed in full and be accompanied by a nonrefundable, \$50.00 filing fee (payable to the Upper Niobrara-White Natural Resources District), and submitted to the District at the address listed on the back of this form.

Date _____ Signature of Applicant _____
 Date Approved _____ NRD Representative _____

SEE OTHER SIDE FOR IMPORTANT PERMIT RESTRICTIONS, RULES AND REGULATIONS

This form must be completed in full and be accompanied by a nonrefundable, \$50.00 filing fee (payable to the Upper Niobrara-White Natural Resources District), and submitted to the District at the address listed below:

**Upper Niobrara White Natural Resources District
430 East 2nd St
Chadron, NE 69337**

Please fill out the application completely and correctly. An incomplete or defective application will be returned to the applicant. Corrections must be submitted to the NRD within 60 days or the application will be canceled. The District will either issue the permit with conditions attached, or deny the permit, no later than 30 days after receipt of a complete and properly prepared application and application fee.

PERMIT RESTRICTIONS

1. Well permits are required prior to construction or a late fee of \$250 will be assessed.
2. Permits are not required for wells designed to pump 50 gallons per minute or less, test holes, or dewatering wells with an intended use of 90 days or less.
3. A permit must be obtained for an existing well that previously did not require a permit but will be modified into a well for which a permit is required as defined in the District's rules and regulations.
4. If construction of the well is not complete within one year of permit approval, a new permit will be required and the previous permit will be cancelled.
5. The well authorized by this permit must comply with well spacing requirements set forth by state statutes and any further spacing requirements set forth by the District.
6. Water wells constructed within 50 feet of a stream bank must have a surface water right for that stream from the Nebraska Department of Water Resources before construction of the well.
7. Any person who commences or causes construction of a well for which the required permit has not been obtained, or who knowingly furnishes false information regarding such permit, shall be guilty of a Class IV misdemeanor.
8. This permit does not register the well with the Nebraska Department of Water Resources. All wells are required to be registered with the Nebraska Department of Water Resources within 30 days after the well is completed.

ADDITIONAL COMMENTS AND/OR RESTRICTIONS: _____

If possible, please mark the proposed well site with a flag